

This drawing is the sole property of Miether Bearing Products and contains confidential and proprietary information. It is being provided to you for your use and may not be disclosed to any third party or used for any other purpose without Miether's prior written consent. The [materials] must be returned to the Company upon its demand. Your acceptance of these materials constitutes your acceptance of the foregoing terms.

C-35134

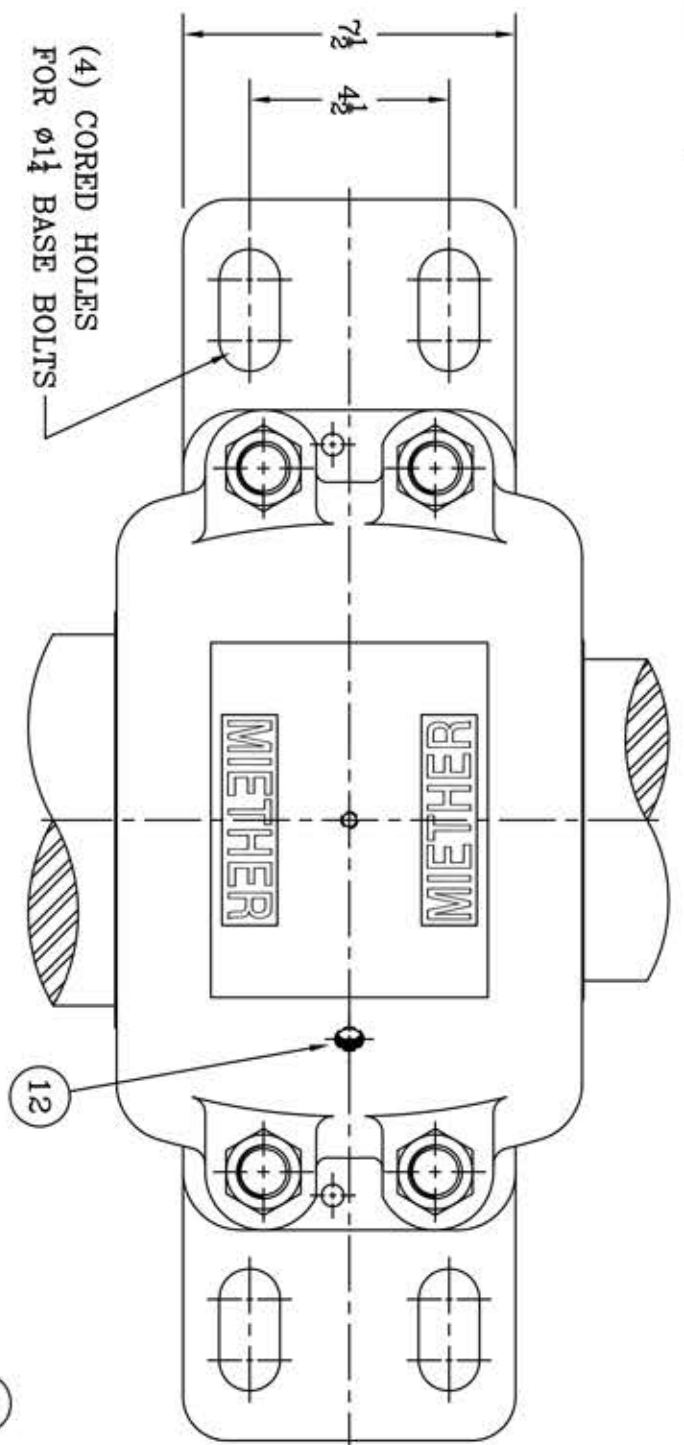

(4) CORED HOLES FOR $\phi 1\frac{1}{4}$ BASE BOLTS

TAPPED FOR $\frac{3}{8}$ -16 NC EYEBOLT

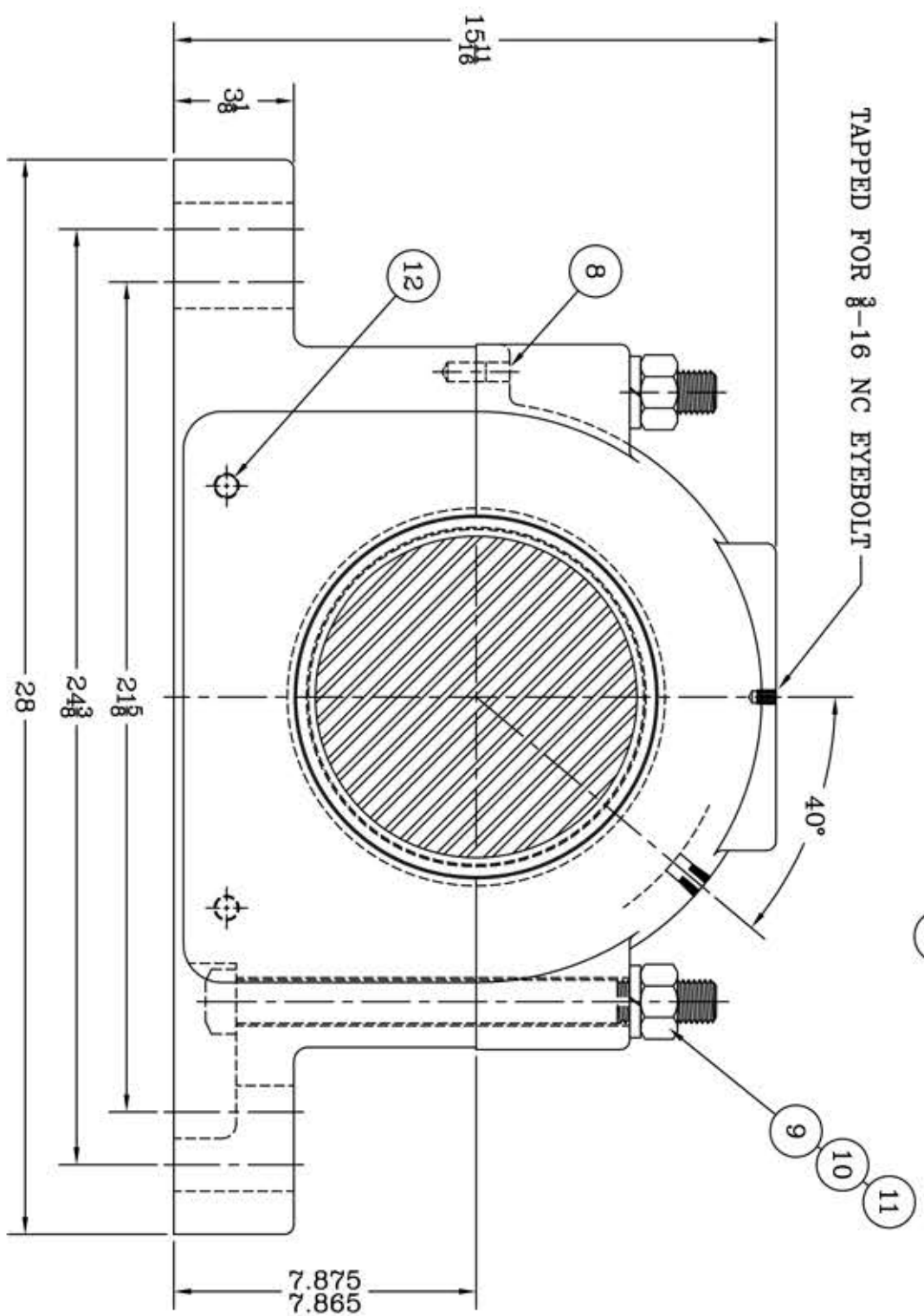

| ITEM | DESCRIPTION | DETAIL | REQUIRED |
|------|--|------------|----------|
| 1 | HOUSING SAFD 238 | C- | 1 1 |
| 2 | SPHERICAL ROLLER BEARING | 22238/W-33 | 1 1 |
| 3 | STABILIZING RING SR-38-32 | A-10555 | 1 0 |
| 4 | LOCKNUT AN-38 | B-10423 | 1 1 |
| 5 | LOCKWASHER W-38 | 00253 | 1 1 |
| 6 | TRIPLE SEAL RING LER 160 | A-10590 | 1 1 |
| 7 | TRIPLE SEAL RING LER 171 | A-10593 | 1 1 |
| 8 | DOWEL $\phi 1/2$ x 1" LONG | | 2 2 |
| 9 | CAP BOLT SQUARE HEAD Gr 5 $1\frac{1}{8}$ -7 NC x 12 1/2 LONG | | 4 4 |
| 10 | CAP BOLT HEX NUT $1\frac{1}{8}$ -7 NC | | 4 4 |
| 11 | LOCKWASHER $1\frac{1}{8}$ SPLIT MED. | | 4 4 |
| 12 | PIPE PLUG $\frac{3}{8}$ -18 NPT | | 3 3 |

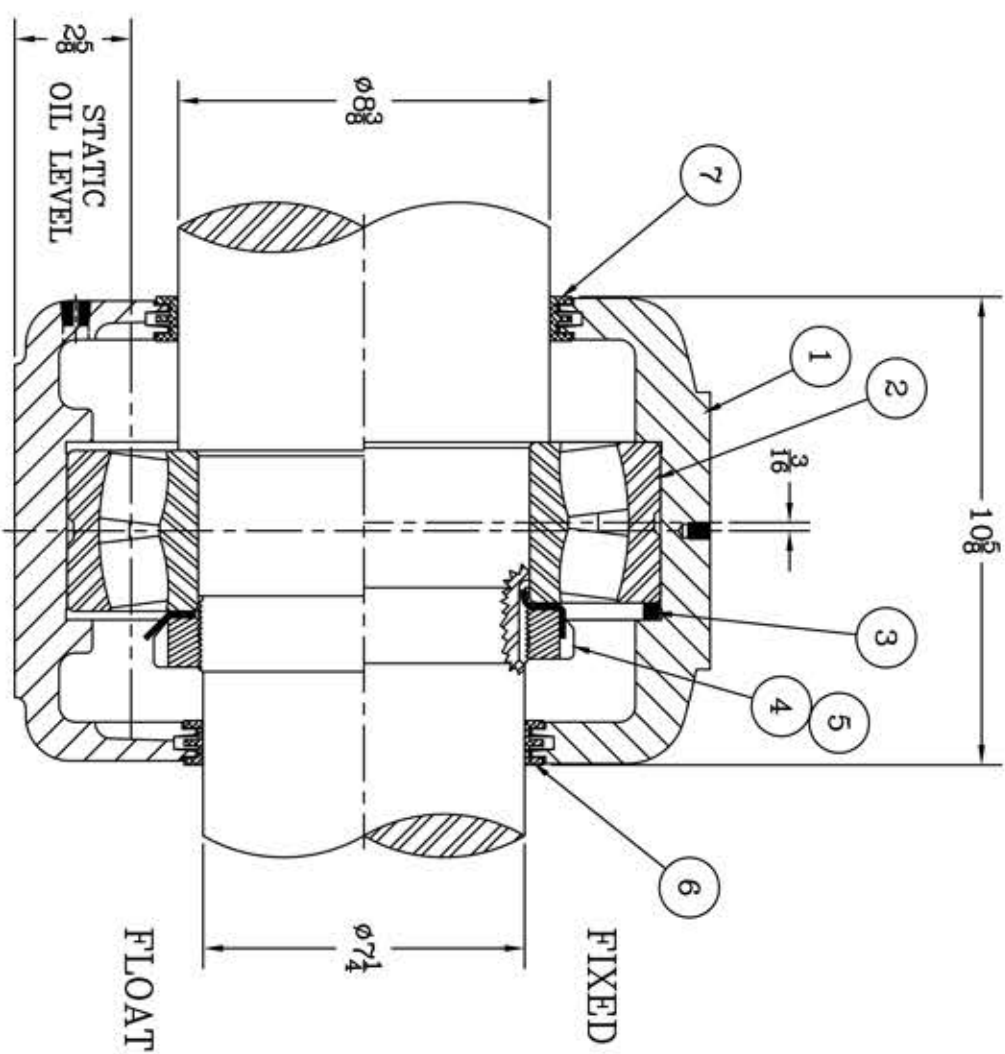

REVISIONS

| SYMBOL | DESCRIPTION |
|--------|-------------|
| C | |
| D | |
| E | |
| F | |
| G | |
| J | |
| K | |

TOLERANCE: UNLESS OTHERWISE SPECIFIED
 FRACTIONS $\pm 1/32$ " ANGLES $\pm 0^\circ 30'$
 DECIMALS $\pm .005$ WELD $\pm 1/16$ "
 CASTING $\pm 1/16$ "

A.I.S.I. STANDARD FINISHES

| MICRO-INCH VALUE | FINISH |
|------------------|--------|
| 16 | C |
| 32 | D |
| 63 | E |
| 125 | F |
| 250 | G |
| 500 | J |
| 1000 | K |

AN ALCO INDUSTRIES COMPANY
 BEARING PRODUCTS
 ODESSA, TX. USA

SAFD 22238 08-06 x 07-04
 ASSEMBLY DRAWING

SCALE 1 = 3
 DRAWN PCF
 DATE 11/9/12
 CHK:

ASSEMBLY NO.
 DRAWING NO.
 C-35134